

Extra model of A3 sized flatbed UV inkjet printer

UJF-3042 MkII EX

Creating More Value

1 print setting to complete the **4** *STEPS*.

The 4 print heads configuration enables an additional attachment of white, clear and primer ink together with the full color (CMYK) of base as 8 bottles of ink can be mounted. A current process of manual apply of primer and an extra job of surface treatment will be finished by one print setting of this new printer.

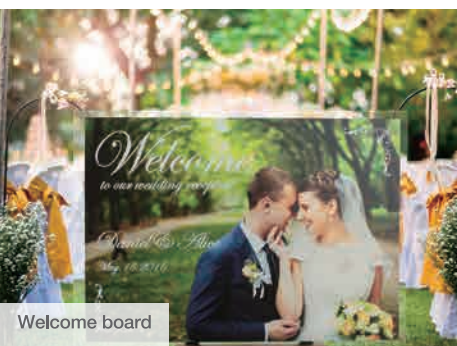
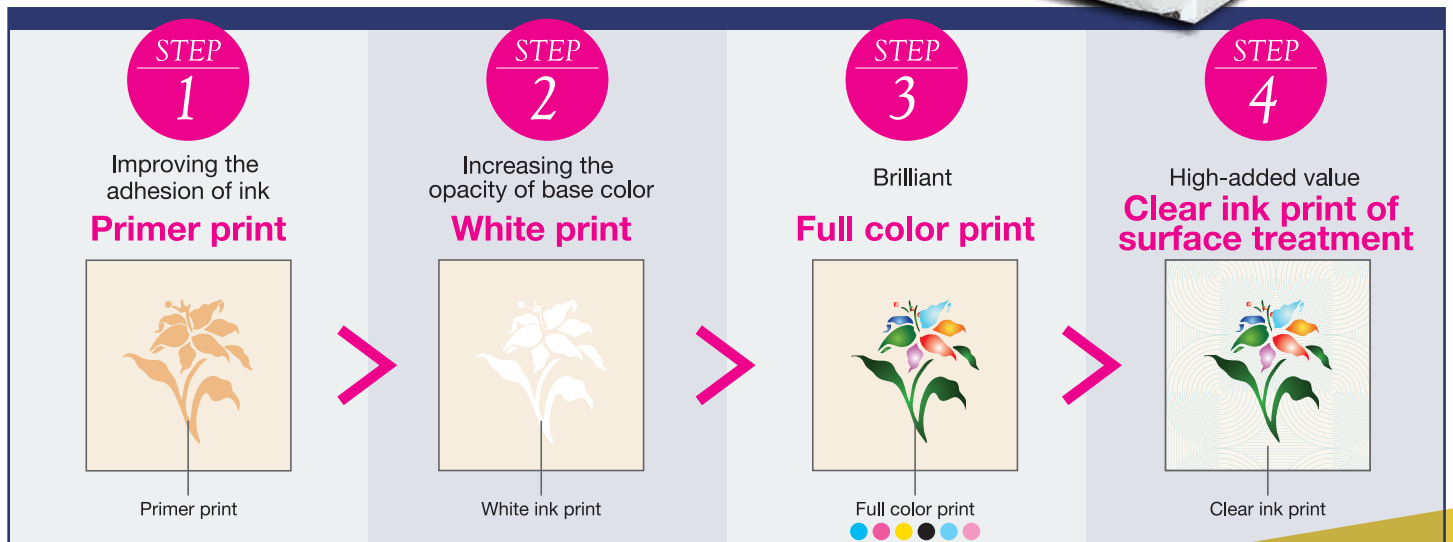

From primer applying to clear surface treatment, only one printer can realize the high-value added printings.

Inkjet primer improving the adhesion of ink

If the adhesion with the material is not good by the color ink alone, it can be improved by applying the inkjet primer.

Because the inkjet method can be applied partially only the necessary area with the necessary volume of primer while taking advantage of the texture of the material, differently from the full-area applying of primer by hand.

It is utilized to improve the adhesion of materials like resin-based goods, glasses, metals and kinds of products with surface coating.



Chrystal trophy

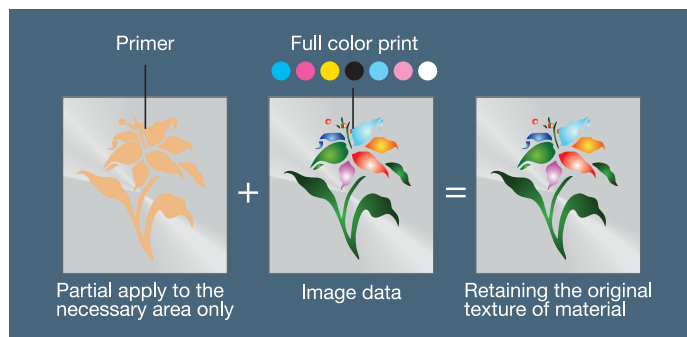

Effective to a transparent or deep color media White ink increasing the opacity

Printing by the white ink as the base of full color image can realize more brilliant expression of the print on a transparent or deep color media. Moreover, Max. 2 bottles of white ink attachment will enhance the opacity of high dense white print in a short time.

Printing on a deep color media



With white

Without white

Surface treatment by clear ink enhances the design effect

With the [Glossy finish] for bright glossiness and the [Matt effect] for muted frosting, [Embossed print] by partial multiple layers, the high value-added print is available by the utilization of clear ink. It adds the glossiness, 3-D appearance, texture and premium feel. Plus, the texture library up to 129 types is ready as the swatch on Adobe Illustrator (*) with the clear ink. Expression of those textures can accompany more elaborated design to the print.

* It is supported on Adobe Illustrator ver. CS or later.



Specifications

		UJF-3042Mk II EX	
Printhead		On-demand piezo printhead (4printheads arranged in a staggered line)	
Print resolution		Maximum: 1200 x 1200 dpi	
Maximum printable area		Width: 300mm Length : 420mm (A3 size)	
Ink	Type/Color	LH-100 (C, M, Y, K, Lc, Lm, W, Cl) LUS-120 (C, M, Y, K, Lc, Lm, W, Cl) LUS-150 (C, M, Y, K, W) PR-200 (Primer)	
	Packaging	LH-100, LUS-120, PR-200: 250 ml, 1L bottle supply system LUS-150: 1L bottle supply system	
Thickness		153mm (6in) or less	Weight 5kg (11lb) or less
Certifications		VCCI class A / FCC class A / ETL UL 60950-1 / CB / CE Marking (EMC, Low voltage, Machinery directive, and RoHS) / REACH / Energy Star / IEC60825-1	
Interface		Ethernet / USB2.0	
Noise level		Standby mode: 55dB or less (FAST-A, measured 1 m away from the source at front, back, right and left sides,)Continuous operation: 65 dB or less Discontinuous operation: 70 dB or less	
Power supply		Single-phase AC100-240V, ±10%, 50/60Hz ±1Hz	
Power consumption		1000 W or less	
Operational environment	Temperature	20 - 30 degC (68 - 86 degF)	
	Humidity	35 - 65%Rh	
	Recommended Temperature	20 - 25 degC (68 - 77 degF)	
	Temperature change	±10 degC (±50 degF) /h or less	
Dust level		Equivalent to a general office floor level	
RIP software		RasterLink6 (Bundled)	
Dimensions (W x D x H) *1		1,355mm x 1,290mm x 856mm (53.4 in x 50.8 in x 33.7 in)	
Weight		135kg (297.6 lb)	

*1: The height(H) does not count the height of ink bottle.

check!

Lineup of wide variety of ink



LH-100 with high scratch fastness

Suitable to print widely on a smartphone case, key holder and wooden blocks etc. due to the strong scratch fastness.



Water bottle

LUS-120 stretches up to 170% !

It allows for soft media to print with great beauty and durability. Very suitable for printing to flexible materials such as leather and polyurethane.



Leather goods

LUS-150 is very suitable to print on acrylic

Flexible ink of highly brilliant coloring with stretch ability up to 150%. It is usable to print on the wide range of goods, not only soft materials also acrylic and glasses due to the good matching.



Acrylic guide plate

* LH-100, LUS-120 and LUS-150 are GREENGUARD Gold certification ink. (PR-200 is excluded.)

●Some of samples in this catalogue are artificial renderings. ●Specifications, design and dimensions stated in this catalogue may be subject to change without notice for technical improvements etc. ●The corporate names and merchandise names written in this catalogue are the trademark or registered trademark of the respective corporations. ●Inkjet printers print using extremely fine dots, so colors may very slightly vary after replacement of print heads. ●Also note that if using multiple printer units, colors could vary slightly from one unit to other(s) due to slight individual differences. ●The specifications described in this catalog are as of May 2019.



MIMAKI ENGINEERING CO., LTD.

2182-3 Shigeno-Otsu, Tomi-city, Nagano, Japan
TEL: +81-268-64-2281

Mimaki Global Network

USA MIMAKI USA, INC.
Brazil MIMAKI BRASIL COMERCIO E IMPORTACAO LTDA
India MIMAKI INDIA PRIVATE LIMITED
Taiwan MIMAKI ENGINEERING (TAIWAN) CO.,LTD.
Singapore MIMAKI SINGAPORE PTE. LTD.

Europe MIMAKI EUROPE B.V.
Indonesia PT. MIMAKI INDONESIA
Australia MIMAKI AUSTRALIA PTY. LTD.
China SHANGHAI MIMAKI TRADING CO.,LTD.
Thailand MIMAKI (THAILAND) CO.,LTD.